



Installation and Operation Instructions

Tools Needed for Installation:

- 9/16" wrench for jack mounting bolts

Replacement Parts

Part #	Description	Qty.
88-03-7030	LED Replacement Light	1
88-03-7020	Light Switch Replacement	1
88-03-7025	Lift Switch Replacement	1
88-03-7040	Manual Crank Handle	1
88-03-7015	Cap/Cover for Manual Drive Opening	1
88-03-7010	Fuse - 30 Amp Slow Blow	1
88-03-7035	Gasket for Gearbox Cover	1



2¼" Flip™ jack foot with 12V Electric Jack

WARNING

- **Read entire instruction manual before using this product. Failure to do so can result in serious injury or death.**
- **Chock tires on both sides of trailer and in both directions while supporting trailer with jack foot.**
- **To avoid the risk of electric shock, disconnect all negative battery cable connections before removing or installing electric jack.**
- **Never exceed maximum tongue weight and capacity ratings.**
- **Never operate jack electrically with the manual crank handle in place.**
- **Replace worn or faded safety labels immediately.**
- **Before each use inspect jack tubes and replace if bent or damaged.**

CAUTION

- **Always use adequate personal protective equipment when installing.**
- **Avoid pinch points between jack extension, spacer ring, jack, and trailer frame when retracting jack.**
- **Pinch/crush hazard. Keep clear of area directly below jack while in operation.**
- **To avoid jack damage, do not continue to retract or extend jack after it has reached maximum travel limits.**

Jack Installation



Never exceed maximum equipment ratings.

STEP 1

Locate trailer on a flat level surface, such as a driveway or parking lot (*Figure 1*). Chock both sides of the trailer in both directions, and set tow vehicle parking brake. Keep trailer coupled to tow vehicle, or place jack stands under trailer tongue to support trailer without the use of the tongue jack. Disconnect trailer plug, safety chains, and safety breakaway cable from the tow vehicle and move them out of the way.

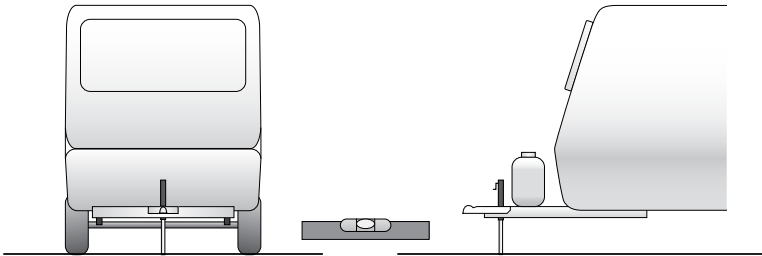

Install jack with trailer parked on level ground both side-to-side and front-to-back.

Figure 1

CAUTION

Always wear adequate personal protection equipment while installing.

Wear safety glasses.

To avoid jack damage, do not continue to retract or extend jack after it has reached maximum travel limits.



To avoid the risk of electric shock, disconnect all negative battery cable connections before removing or installing electric jack.

STEP 2

If your current jack is an electric model (if not skip to STEP 3):

- a) Disconnect the negative battery cable to make sure there is no power being supplied to the jack.
- b) Disconnect any positive or negative power leads to the jack, and cap them appropriately where necessary.

STEP 3

Remove current jack:

Retract the jack so that the trailer tongue weight is being supported by the tow vehicle or jack stands - not by the tongue jack. Using a wrench, remove the bolts, nuts and washers that secure the jack mounting plate to the trailer's A-frame coupler. Remove the jack from the coupler.

STEP 4

Install new Fastway® electric jack:

- a) Remove the jack from the packaging.
- b) Slide the jack down through the A-frame mounting hole.
- c) Align the jack over the mounting holes with the LED light on the front of the gear box pointing forward toward the tow vehicle (See Figure 2).
- d) Use the supplied 3/8" bolts, or your original mounting bolts, to mount the jack to the A-frame coupler.
 - i. Thread each bolt into the mounting holes by hand.
 - ii. Insert all bolts loosely before tightening any single bolt so that the jack is free to move to line up all three mounting holes, slots, and bolts.
- e) Tighten all bolts securely.
- f) Torque all bolts to between 15-20 ft-lbs.

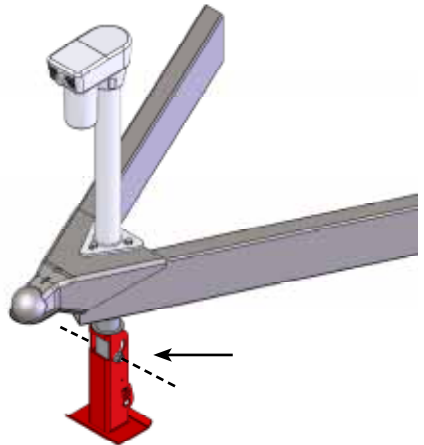

Figure 2

STEP 5

Connect power to jack:

- a) Open the in-line fuse case and remove fuse.
- b) Route the power cable to the battery compartment along the trailer frame in a location that does not interfere with other items on the trailer tongue, such as the propane hose or hitch brackets. Use cable ties or cable brackets to secure the power supply cable securely to the frame.

- c) Attach the positive cable (+) directly to the positive post of the battery and re-connect all other positive battery terminal connections. The positive cable has a red ring terminal and the in-line fuse case.
- d) Attach the ground cable (-) directly to the negative post of the battery and re-connect all other negative battery terminal connections. The ground cable has a black ring terminal.
- NOTE: We recommend attaching the ground cable directly to the battery post for a cleaner, more reliable ground. If the trailer frame is well grounded directly to the negative (-) battery terminal, attaching the jack ground directly to the trailer frame is acceptable. This connection must be a clean, metal-to-metal connection and must be kept free from corrosion for the jack to operate properly.
- e) Coat each battery terminal connection with corrosion resistant electrical grease.
- f) Replace the in-line fuse.

STEP 6

Install Flip jack foot:

Follow instructions included in the Flip jack foot package to complete installation of the Flip jack foot. **SKIP STEPS 2 AND 3.** Your jack has already been pre-drilled for easy installation.



Do not operate jack electrically with manual crank handle in place.

STEP 7

Operating Jack Manually:

- If your jack will not operate electrically for any reason, you can use the included crank handle to operate the jack manually. You may also use a socket wrench with a 3/8" drive to operate the jack manually.
- a) Remove the in-line fuse from the jack power supply cable.
- b) Remove the plastic drive cap on the top of the gear housing.
- c) Insert the crank handle into the square socket. Crank clockwise to retract the jack, and counter-clockwise to extend the jack.
- d) When finished, remove the handle, replace the plug cap, and replace the fuse.

Maintenance

Before each use, check to make sure all bolts on the mounting plate, and jack foot are secure and properly tightened.

Periodically check all electrical connections for proper ground, clean connection, and wire damage. Clean, repair, or replace as necessary.

Remove gear housing cover at least annually and inspect for proper lubrication. Add a coat of lithium based grease as needed to keep gears well lubricated.

Always keep plastic cap to manual operation drive opening in place and in good repair. Failure to do so may allow water into the gear housing of the jack and over time may damage gears and/or motor.

If water does get into the gear housing, remove the top cover and allow the housing to dry thoroughly taking care not to damage the housing gasket. Apply a coat of lithium based grease to gears. Carefully replace the gear housing gasket and cover.

If the manual drive cap or gear housing gasket have been lost or damaged, replace them immediately.

TROUBLESHOOTING

Symptom	Likely Problem	Recommended Repair
Light on the jack works, but jack doesn't run.	Poor electrical connection or low battery does not supply sufficient voltage to jack.	Check and clean all electrical connections. Re-charge battery.
Jack blows fuse just after starting to run.		
Jack continues to blow fuses after checking and cleaning all electrical connections.	Jack or electrical supply has a short.	Consult a qualified service technician to find and repair problem.
Jack operates for a time then shuts down, but does not blow fuse.	Internal circuit breaker has tripped because of excessive wire resistance and heat.	Let jack sit for several minutes and cool. Circuit breaker will automatically reset itself.

Limited Warranties

Progress Mfg. Inc. warrants, to the original purchaser, this product against defects in the materials and workmanship for a period of one year, from the date of purchase. This warranty does not cover damage due to normal wear and tear, misuse, neglect, abuse, or product finish. Progress Mfg. Inc. reserves the right to repair or replace the defective part(s) at their discretion. Replacement of product or refund constitutes the fulfillment of all liabilities of Progress Mfg. Inc. under this warranty. For questions about warranty coverage and warranty authorization, please call (877) 523-9103. If warranty repair or replacement is approved, send the entire product and proof of purchase, shipping pre-paid, to: Progress Mfg. Inc., 533 South 500 West, Provo, UT 84601

Fastway e2 Hitches Less Hassles - Less Stress - Safer Towing



e2™ Round Bar Hitch



e2™ Trunnion Hitch

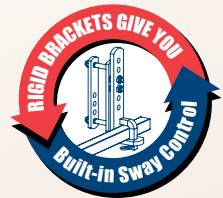

Integrated Sway Control™ - less hassles

- Sway control built-in
- No add-on sway bar hassles or restrictions
- Excellent weight distribution
- Better steering and braking control

Fastway e2 - Faster, Easier.™

For more information visit www.FastwayTrailer.com

Other Great Fastway Products!

The Fastway® Zip™ breakaway cable's coiled design keeps your cable from dragging!



Fastest and easiest tandem axle wheel chock ever!

ONEstep™
tandem axle wheel chock

Easy as...



Fastway® Trailer Products
533 South 500 West, Provo, UT 84601
(877) 523-9103
www.FastwayTrailer.com

© 2010 Copyright Progress Mfg. Inc., All rights reserved.

JPIN_0910

All products US & foreign patents pending.